

CERTIFICATE OF LOCATION OF GOVERNMENT CORNER

NORTHEAST Corner of Section 24, Township 107, Range 43, 5TH P.M.

STATE OF MINNESOTA, County of MURRAY

At the corner location shown on the sketch:

On 05-18-2011 found a 3/4" iron.
DATE

left monument as found, lowered monument, removed monument (explain)

On _____ placed a _____
DATE

SKETCH OF REFERENCE TIES

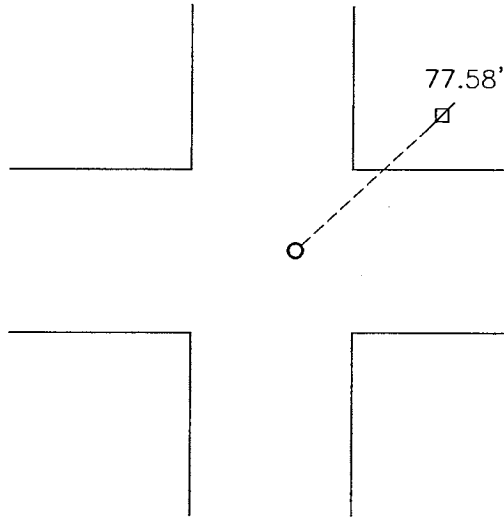

Minnesota State Plane Coordinate
System Murray County Datum
NAD83 (1996)

N: 179496.873
E: 453491.341

Nail and bottle cap in utility pole NE 77.58'

Statement of evidence relative to this corner location is on back of page.

I hereby certify that this document and the data contained herein was prepared by me or under my direct supervision.

SIGNATURE

1/23/12
DATE

Registration No. 43844

- Land Surveyor, Professional Engineer
 County Surveyor, County Engineer

OFFICE OF THE COUNTY RECORDER
County of _____

I hereby certify that this document was filed in the Co. Recorders office at _____ .M on the _____ day of _____ A.D. 20 _____

County Recorder JAN 25 2012

By James V. Johnson Deputy

DOCUMENT NO. _____

Statement of Evidence

(No Date) J. W. Myers did the original survey of the township lines.

(No Date) Minnesota Department of Transportation highway plans noted that the corner is to be 2.5' east of the centerline.

On May 18, 2011, Bueltel-Moseng Land Surveying found a $\frac{3}{4}$ " iron at the corner. The corner is 2'± east of the centerline.